



**\$365,000**

## **1669 MINERAL LOOP DRIVE, PALM BAY, FL, 32907**

<https://austingarnerrealestate.com>

**\$10K PRICE DROP!** Welcome to your dream home! Built in 2022, this stunning contemporary residence combines modern elegance with a relaxed direct lake view, from the family room, dining area, primary bedroom & screened lanai. The ultimate in comfort & style. Step inside to an expansive open floor plan that seamlessly connects the kitchen, dining [...]

- 3 beds
- 2 baths
- Single Family Residence
- Residential
- Active
- 1768 sq ft

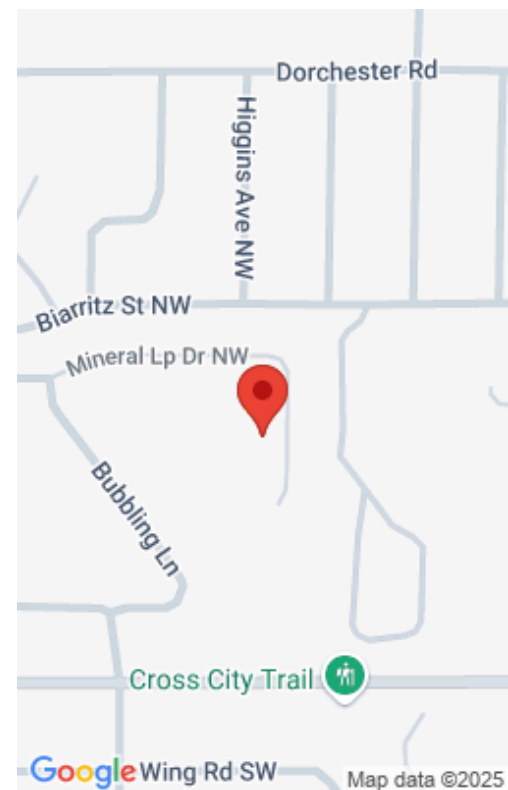

# Basics

**Category:** Residential

**Status:** Active

**Bathrooms:** 2 baths

**Lot size:** 0.16 sq ft

**Subdivision Name:** Avery Springs

**Lot Size Acres:** 0.16 acres

**Zoning:** Single Family

**Type:** Single Family Residence

**Bedrooms:** 3 beds

**Area:** 1768 sq ft

**Year built:** 2022

**Bathrooms Full:** 2

**Rooms Total:** 7

**County:** Brevard

# Building Details

**Construction Materials:** Block, Concrete, Stucco

**Sewer:** Public Sewer

**Current Use:** Residential, Single Family

**Roof:** Shingle

**Architectural Style:** Ranch

**Heating:** Central, 1

**Stories:** 1

**Levels:** One

# Amenities & Features



**Laundry Features:** Electric Dryer Hookup, In Unit, Washer Hookup

**Utilities:** Cable Available, Electricity Connected, Sewer Connected, Water Connected

**Parking Features:** Attached, Garage, Garage Door Opener, Gated

**WaterSource:** Public,

**Interior Features:** Breakfast Bar, Ceiling Fan(s), Open Floorplan, Pantry, Smart Thermostat, Walk-In Closet(s), Primary Bathroom - Shower No Tub, Split Bedrooms

**Spa Features:** Community, In Ground

**Exterior Features:** Storm Shutters

**Flooring:** Carpet, Tile

**Association Amenities:** Gated, Maintenance Grounds, Park, Management - Off Site, Pool

**Garage Spaces:** 2, 1

**Appliances:** Disposal, Dishwasher, Electric Range, Electric Water Heater, Microwave, Refrigerator

**Lot Features:** Sprinklers In Front, Sprinklers In Rear

**Patio And Porch Features:** Rear Porch, Screened

**Cooling:** Central Air

## Fees & Taxes

**Tax Assessed Value:** \$3,800

**Association Fee Frequency:** Quarterly

**Association Fee Includes:** Maintenance Grounds

## School Information

**HighSchool:** Heritage

**Middle Or Junior School:** Central

**Elementary School:** Jupiter

## Miscellaneous

**Road Surface Type:** Asphalt

**Listing Terms:** Cash, Conventional, FHA, VA Loan

**Special Listing Conditions:** Standard **Pets Allowed:** Yes





# Courtesy of

**List Office Name:** Weichert REALTORS Hallmark Pro

