



\$260,000

2076 CERULEAN DRIVE, PALM BAY, FL, 32907

<https://austingarnerrealestate.com>

This is a resale. Immaculate-like new with the BEST LAKE and CONSERVATION AREA VIEWS! Welcome to The Timbers at Everlands ~ Palm Bay's Newest 55+ Community. This single-story Hibiscus Model attached home provides the convenience of having everything you need on one level. The open-concept Great Room is comfortably located between the covered patio and [...]

- 2 beds
- 2 baths
- Townhouse
- Residential
- Active
- 1308 sq ft

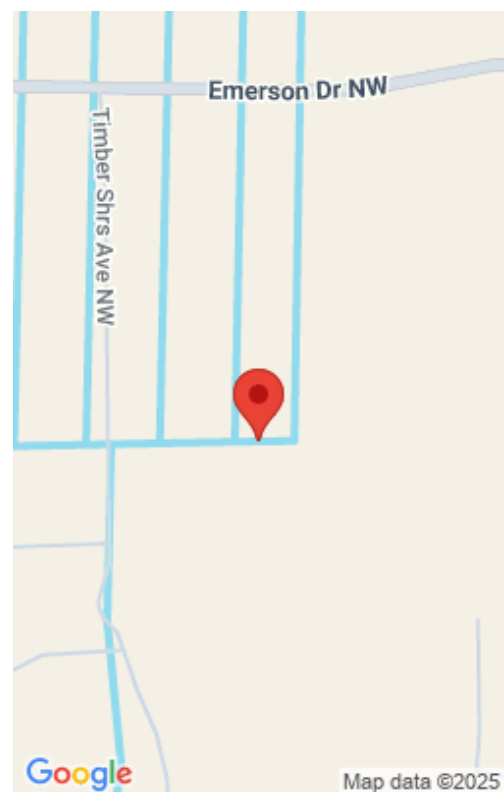

Basics

Category: Residential	Type: Townhouse
Status: Active	Bedrooms: 2 beds
Bathrooms: 2 baths	Area: 1308 sq ft
Lot size: 0.08 sq ft	Year built: 2024
Subdivision Name: The Timbers at Everland	Bathrooms Full: 2
Lot Size Acres: 0.08 acres	County: Brevard

Building Details

Construction Materials: Block, Stucco	Architectural Style: Villa
Sewer: Public Sewer	Heating: Central, Electric, 1
Current Use: Residential	Stories: 1
Roof: Shingle	Levels: One

Amenities & Features

Laundry Features: In Unit	Flooring: Tile
Utilities: Cable Connected, Electricity Connected, Sewer Connected, Water Connected	Association Amenities: Clubhouse, Dog Park, Fitness Center, Gated, Maintenance Grounds, Maintenance Structure, Tennis Court(s), Pickleball, Management - Off Site, Management - On Site, Pool
Parking Features: Attached, Garage, Garage Door Opener	Waterfront Features: Pond
Garage Spaces: 1, 1	WaterSource: Public, 1
Appliances: Dryer, Disposal, Dishwasher, Electric Range, Ice Maker, Microwave, Refrigerator, Washer	Interior Features: Breakfast Bar, Ceiling Fan(s), Open Floorplan, Vaulted Ceiling(s), Walk-In Closet(s), Primary Bathroom - Shower No Tub
Lot Features: Sprinklers In Front, Sprinklers In Rear, Other	Patio And Porch Features: Patio
Exterior Features: Impact Windows	Cooling: Central Air, Electric





Fees & Taxes

Tax Assessed Value: \$214.60 **Association Fee Frequency:** Monthly



School Information

HighSchool: Heritage **Middle Or Junior School:** Central
Elementary School: Discovery



Miscellaneous

Road Surface Type: Asphalt **Listing Terms:** Cash, Conventional, FHA, VA Loan
Special Listing Conditions: Standard **Pets Allowed:** Yes



Courtesy of

List Office Name: EXP Realty, LLC

