



\$729,000

690 GRANT ROAD, PALM BAY, FL, 32909

<https://austingarnerrealestate.com>

Car Enthusiast, Boat or RV Owner, a business owner, a she shed extraordinaire, or a woodworking pro looking to grow the business from home, this property delivers. 34' x 60' Insulsted Steel Building Built to Dade County Hurricane Codes & carport covered concrete slab at the east end of the building. Beautiful 4 Bedrm, 2.5 [...]

- 4 beds
- 3 baths
- Single Family Residence
- Residential
- Active
- 1896 sq ft

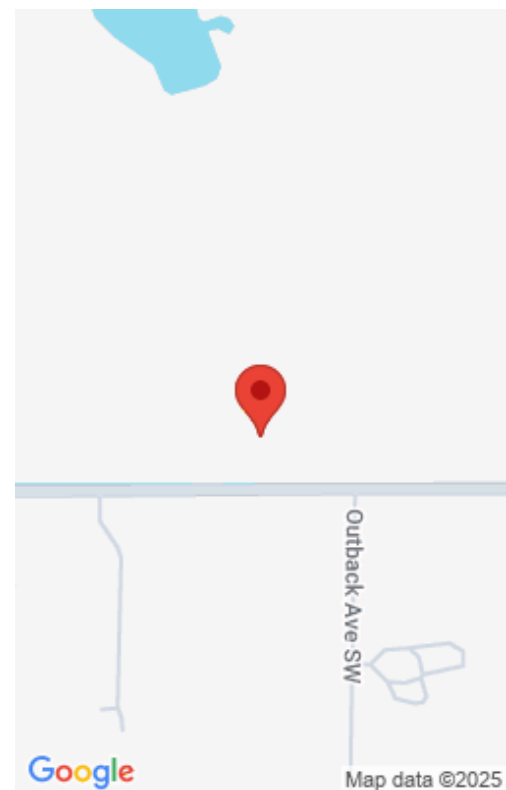

Basics

Category: Residential
Status: Active
Bathrooms: 3 baths
Lot size: 1.29 sq ft
Subdivision Name: None
Lot Size Acres: 1.29 acres
County: Brevard

Type: Single Family Residence
Bedrooms: 4 beds
Area: 1896 sq ft
Year built: 2005
Bathrooms Full: 2
Rooms Total: 11

Building Details

Building Area Total: 2830 sq ft
Sewer: Septic Tank
Current Use: Single Family
Roof: Metal

Construction Materials: Block, Stucco
Heating: Central, 1
Stories: 1
Carport Spaces: 2

Amenities & Features

Flooring: Tile, Vinyl
Fencing: Chain Link
Garage Spaces: 26, 1
Appliances: Dishwasher, Electric Range, Microwave, Refrigerator, Water Softener Owned
Lot Features: Other
Cooling: Central Air

Utilities: Cable Available, Electricity Connected, Water Connected
Parking Features: Additional Parking, Attached, Detached, Garage, Garage Door Opener, Gated, RV Access/Parking
WaterSource: Private, Well,
Interior Features: Breakfast Bar, Ceiling Fan(s), Entrance Foyer, Walk-In Closet(s), Primary Bathroom -Tub with Separate Shower, Split Bedrooms, Breakfast Nook
Patio And Porch Features: Covered, Front Porch, Porch, Rear Porch, Screened



Fees & Taxes

Tax Assessed Value: \$3,359.71

School Information

HighSchool: Bayside

Middle Or Junior School: Southwest

Elementary School: Sunrise

Miscellaneous

Road Surface Type: Asphalt

Listing Terms: Cash, Conventional

Special Listing Conditions: Standard

Courtesy of

List Office Name: Sunshine Realty Brevard

